

1

2

3

4

### Notes: (Unless Otherwise Specified)

1. Waterproof Rate: IP68.
2. Cable Diameter: 6.0 to 8.5 mm
3. Recommend Gland Nut Torque: 9.0 to 10.0 Kgf-cm.
4. Matting No.: GT225500 Series.
5. RoHS Compliant

| REV | ECN# | DESCRIPTION OF REVISION | DRAW BY DATE     | CHECK BY DATE  | APPROVE BY DATE |
|-----|------|-------------------------|------------------|----------------|-----------------|
| A0  |      |                         | Whitney 12/17/19 | Lucas 12/17/19 | Ray 12/17/19    |

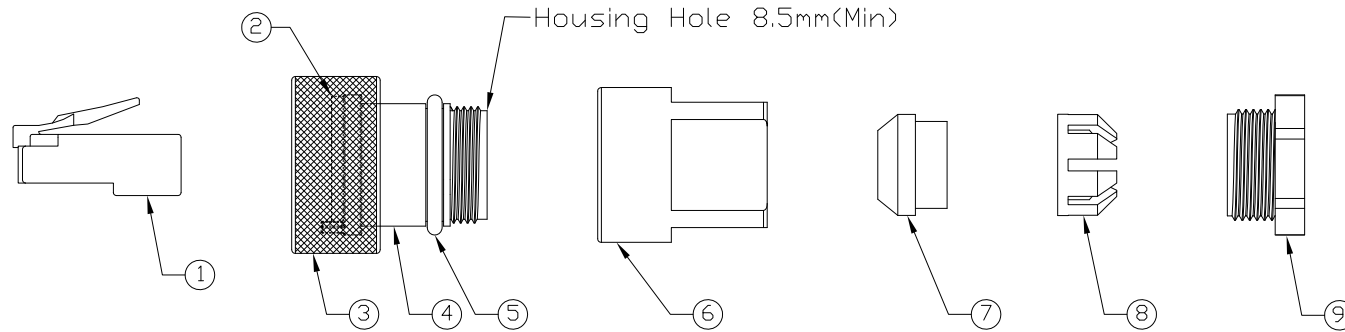

|      |                 |   |     |
|------|-----------------|---|-----|
| 9    | Metal Gland Nut | Copper Alloy<br>Finish: Ni Plated   | 1   |
| 8    | Cage            | Thermoplastic<br>Color: White   | 1   |
| 7    | Gland           | Silicone<br>Color: Red  | 1   |
| 6    | Metal Cover     | Copper Alloy<br>Finish: Ni Plated   | 1   |
| 5    | O-Ring          | Silicone<br>Color: Red  | 1   |
| 4    | Housing         | Thermoplastic<br>Color: Black   | 1   |
| 3    | Metal Screw Nut | Copper Alloy<br>Finish: Ni Plated   | 1   |
| 2    | Rubber Pad      | Silicone<br>Color: Black  | 1   |
| 1    | RJ45 Plug       | Housing: Thermoplastic, Color: Clean<br>Contacts: Copper Alloy, Finish: Au Plated<br>Shell: SPCC, Finish: Ni Plated | 1   |
| Item | Part Name       | Material / Finish   | Qty |

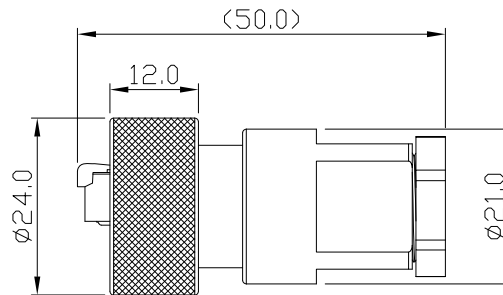

GTC  
DOC.CENTER.ISSUE  
DEC.18.2019  
ONLY FOR  
RELEASE

| TITLE  |      |       |                  |                |                | DRAWING NUMBER          |                             |           | REV. |
|--|------|-------|------------------|----------------|----------------|-------------------------|-----------------------------|-----------|------|
| RJ45 Metal C3 Shielded Field Installable Cable End Screw |      |       |                  |                |                | GT225570-A0             |                             |           | A0   |
| THIRD ANGLE PROJECTION                                   | SIZE | SCALE | DRAW / DATE      | CHECK / DATE   | APPROVE / DATE | TOLERANCES              | UNIT                        | SHEET     |      |
|  | B    | 1:1   | Whitney 12/17/19 | Lucas 12/17/19 | Ray 12/17/19   | X.X ± 0.5<br>X.XX ± 0.2 | X.XXX ± 0.05<br>ANGLES ± 1° | mm<br>1/1 |      |

**USB FIREWIRE.com**

THE INFORMATION CONTAINED HEREIN IS PROPRIETARY AND CONFIDENTIAL TO RR BUSINESS VENTURES, LLC. THE POSSESSOR AGREES TO THE FOLLOWING

1. MAINTAIN THIS DOCUMENT IN CONFIDENCE
2. NOT TO REPRODUCE OR COPY IT
3. NOT TO REVEAL OR PUBLISH IT IN WHOLE OR PART

1

2

3

4